

## FH11

50 Hz

Closed impellers

### FH1102...1121

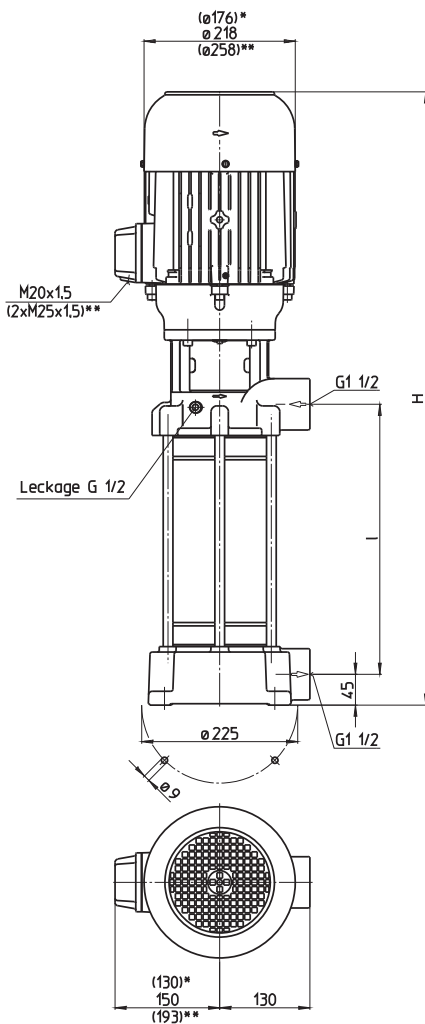

\*) Dimensions for FH1102...1106

\*\*\*) Dimensions for FH1115...1121

Type	Vol. del. at manom. del. head l/min /m	Height H mm	Length l mm	Weight kg	Power kW	Voltage 3 ~ V	Fre- quen- cy Hz	Current A	Speed 1/min
<b>FH1102A18</b>	150/19	643	212	39	1.3	220-240 380-415	50 50	4.85 2.80	2900 2900
<b>FH1103A18</b>	150/29	643	212	40	1.5	220-240 380-415	50 50	5.5 3.2	2880 2880
<b>FH1104A28</b>	150/38	765	308	44	1.7	220-240 380-415	50 50	6.24 3.60	2890 2890
<b>FH1105A28</b>	150/48	798	308	48	1.9	220-240 380-415	50 50	6.84 3.95	2900 2900
<b>FH1106A28</b>	150/58	798	308	50	2.6	220-240 380-415	50 50	9.30 5.35	2880 2880
<b>FH1107A31</b>	150/67	869	340	60	3.0	220-240 380-415	50 50	10.7 6.2	2930 2930
<b>FH1108A38</b>	150/78	933	404	63	3.3	220-240 380-415	50 50	11.6 6.7	2930 2930
<b>FH1109A38</b>	150/88	933	404	64	4.0	220-240 380-415	50 50	14.50 8.35	2920 2920
<b>FH1110A47</b>	150/98	1028	500	66	5.0	220-240 380-415	50 50	17.3 10.0	2920 2920
<b>FH1111A47</b>	150/106	1058	500	72					
<b>FH1112A47</b>	150/118			73					
<b>FH1113A50</b>	150/128	1090	532	74	5.5	220-240 380-415	50 50	18.9 10.9	2915 2915
<b>FH1114A57</b>	150/138	1154	596	75	7.5	380-415	50	14.3	2950
<b>FH1115A57</b>	150/149	1232	596	107					
<b>FH1116A66</b>	150/158	1328	682	109					
<b>FH1117A66</b>	150/168			110	9.0	380-415	50	16.7	2955
<b>FH1118A66</b>	150/178			113					
<b>FH1119A76</b>	150/188	1424	788	117					
<b>FH1120A76</b>	150/198			118					
<b>FH1121A76</b>	150/206			119					

**Pressure Boosting Pumps**

series TH and FH use **closed impellers** in order to minimize power consumption and to optimize hydraulic pump efficiencies.

In addition, the TH series offers high pressures at short immersion depths. Inline pumps of the series FH can be used as **boosting pumps** if provided with positive inlet pressure. This inlet pressure can be provided by the central coolant supply or a feed pump. In such a setup, pumps of the series FH can raise the incoming pressure by up to 26 bar.

A **frequency converter** can be supplied for **special applications** or for matching the pump characteristic to a specific duty point.

See page "Control/Regulation" in the Technical Information section of this catalog for further information.

**Applications**

- Types of fluid
  - Industry water
  - coolants
  - cooling/cutting oils
- Kinematic viscosity
  - ...25 mm<sup>2</sup>/s (25 cSt)
- Pumping temperature
  - 0...80° C

**Construction**

Pump body	cast iron
Cover	cast iron
Impellers	CrNi-steel
Shaft	CrNi-steel
Diffusers	CrNi-steel
Mechanical seal	SiC
O-rings	Viton
<b>Noise level</b>	
FH1102...FH1106	63 dBA
FH1107...FH1114	71 dBA
FH1115...FH1121	74 dBA

